

Clinching Bolt

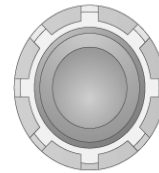

Head Type / Platform Type	Thick Head / Knurled Platform
Material	Stainless Steel
Finish	Natural

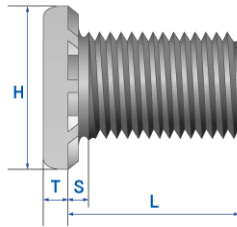

H = Head Diameter
 T = Head Thickness
 L = Body Length

*Dimensions in millimeters

Thread Size	H max.	T max.	S max.	Hole Size (+0.13)	Sheet Thickness min.	Dist. C/L hole to edge min.	Hole in mating part max.	Tightening Torque(Nm) rec.
M4	6.16	1.00	2.20	4.00	0.8	8.0	5.0	3.5
M5	7.80	1.14	2.40	5.00	0.9	10.7	6.5	4.4
M6	9.40	1.27	2.80	6.00	1.0	11.5	7.5	10.0
M8	12.5	1.78	3.50	8.00	1.5	12.7	9.5	22.0
M10	15.7	2.30	6.20	10.00	2.3	13.7	11.5	37.0

Thread Size	Available Lengths(L)													
M4	8	10	12	14	15	16	18	20	25	30				
M5	8	10	12	14	15	16	18	20	25	30				
M6		10	12	14	15	16	18	20	25	30	35	40	50	60
M8			12	14	15	16	18	20	25	30	35	40	50	60
M8				14	15	16	18	20	25	30	35	40	50	60